

c/o Association Services, Inc.  
1110 Park Place, Suite 101  
Coeur d'Alene, ID 83814  
(208) 676-8626 – Office  
(208) 676-8603 – Fax

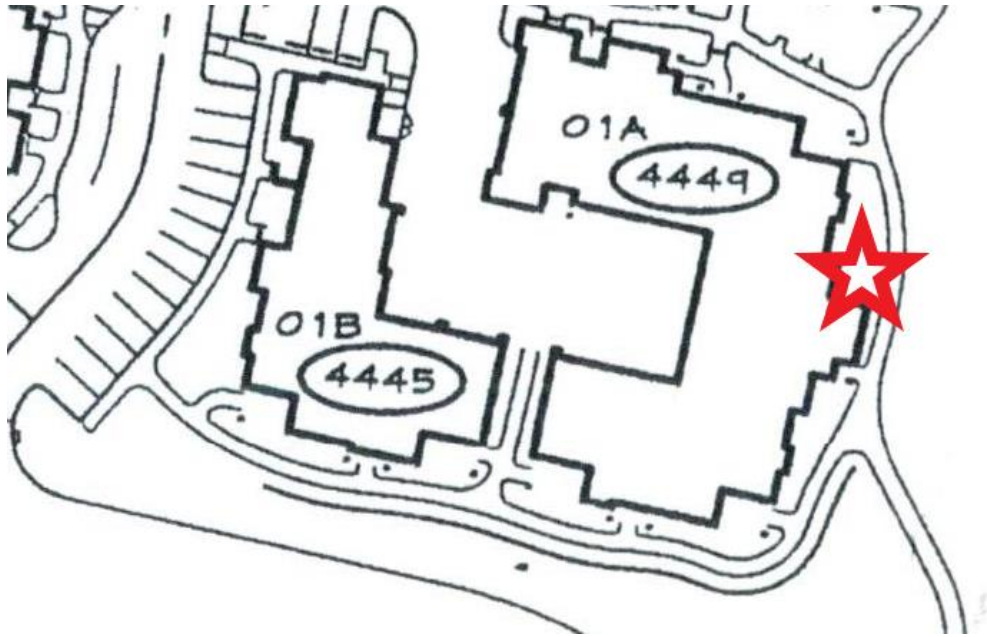

## Maple Tree Removal

Dear Residents,

The maple tree on the east side of 4449 Greenchain Loop was evaluated by an arborist, and it was recommended that it be removed due to encroachment on the building, which would have continued to cause issues and risk as it grew. The tree will be removed within the next few days, and a replacement planted later in the fall with other plantings.

If you have any questions, please contact Ben with Association Services at [ben@asi-hoa.com](mailto:ben@asi-hoa.com) or 208-676-8626. -Thank You.